

TASHKOO GRP Ex Enclosures

- ✓ PROTECTED UP TO IP67 AGAINST DUST AND WATER, WITH A WIDE RANGE OF DIMENSIONS TO MEET ALL CUSTOMERS REQUIREMENTS
- ✓ WIDE RANGE OF GLANDS AND TERMINALS
- ✓ ATEX EEx 'e' CERTIFIED



These enclosures are manufactured from glass-reinforced polyester, which is highly resistant to corrosion, petrochemical products and fats, combined with high impact strength and lightweight. They have been designed to meet the highest standards of protection demanded by electrical and electronics designers and specifiers, serving both industrial and aerospace markets. They are the ideal choice for housing electrical and electronic equipment of high value.

TECHNICAL SPECIFICATION

CONSTRUCTION:	ALL ENCLOSURE BODIES AND LIDS ARE MANUFACTURED FROM GLASS REINFORCED POLYESTER WHICH IS HIGHLY RESISTANT TO CORROSION, PETROCHEMICAL PRODUCTS AND FATS, COMBINED WITH HIGH STRENGTH AND LIGHT WEIGHT. LIDS ARE SECURED WITH STAINLESS STEEL FASTENERS WHICH LOCATE OUTSIDE THE SEALED AREA.
IP RATING:	BECAUSE OF THEIR DESIGN USING A RAISED RIB ON THE BOX BODY AND A RECESSED CHANNEL IN THE LID HOUSING A CONTINUOUS NEOPRENE SEAL THE STANDARD OF IP 66 IS ACHIEVED AS STANDARD WITH IP 67 VERSIONS AVAILABLE AT A SLIGHT INCREASE IN COST.
TEMPERATURE RANGE:	USING THE STANDARD NEOPRENE GASKET -40°C TO +80°C OR USING THE OPTIONAL SILICON GASKET -50°C TO + 120°C. FIRE RESISTANT TYPES ARE AVAILABLE TO SPECIAL ORDER WITH CERTIFICATION TO IEC 331 750°C.
FINISHES:	AVAILABLE AS STANDARD GREY COLOUR RAL 7001. OPTIONAL COLOURS TO CUSTOMER SPECIFICATION ARE AVAILABLE . RFI SHIELDING FOR EMC COMPLIANCE AND SCREEN PRINTING.
CUSTOMISING:	A FULL RANGE OF SECONDARY OPERATIONS IS AVAILABLE AT VERY COMPETITIVE PRICES INCLUDING DRILLING AND TAPPING, MACHINING, ENGRAVING, FITTING OF CABLE GLANDS AND ACCESSORIES, PLUGS AND SOCKETS, AND A FULL RANGE OF TERMINAL BLOCKS AND FITTINGS.
EEx'e' APPROVAL:	ALL THE CEP RANGE IS AVAILABLE WITH FULL EEx'e' CERTIFICATION COMPLETE WITH A WIDE RANGE OF TERMINALS AND CABLE GLANDS.
ACCESSORIES:	INTERNAL HINGES, MOUNTING PLATES, EXTERNAL HINGES, EXTERNAL MOUNTING FEET AND WIRE LOCK SCREWS ARE ALL AVAILABLE AT EXTRA COST.

Dimensions and Part Numbers:

REFERENCE	LENGTH (B)	WIDTH (A)	DEPTH (C)
GRP 807555	75	80	55
GRP 117555	75	110	55
GRP 167555	75	160	55
GRP 197555	75	190	55
GRP 197575	75	190	75
GRP 237550*	75	230	55
GRP 121290	120	122	90
GRP 261690	160	260	90

REFERENCE	LENGTH (B)	WIDTH (A)	DEPTH (C)
GRP 361690	160	360	90
GRP 561690*	160	560	90
GRP 252512	250	255	120
GRP 252516	250	255	160
GRP 402512	250	400	120
GRP 402516	250	400	160
GRP 404012	405	400	120

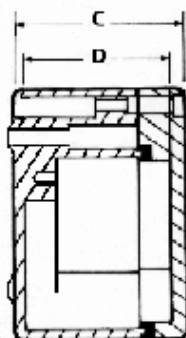
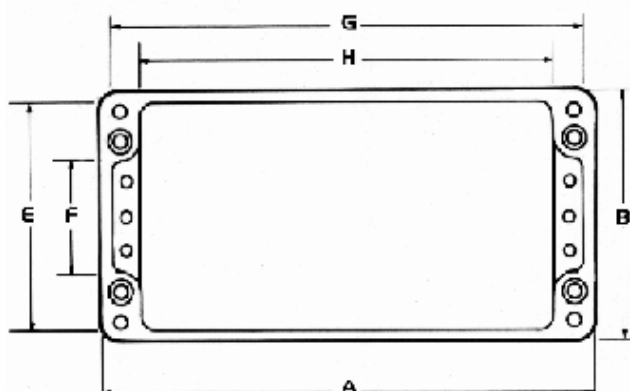

Supplier:



TASHKOO Limited

Hertfordshire

United Kingdom

Tel: +44 (0) 1923 518589

Email: info@tashkoo.com

www.tashkoo.com

TASHKOO

SS Ex Enclosures

- ✓ PROTECTED UP TO IP67 AGAINST DUST AND WATER, WITH A WIDE RANGE OF DIMENSIONS TO MEET ALL CUSTOMERS REQUIREMENTS
- ✓ WIDE RANGE OF GLANDS AND TERMINALS
- ✓ ATEX EEx 'e' CERTIFIED

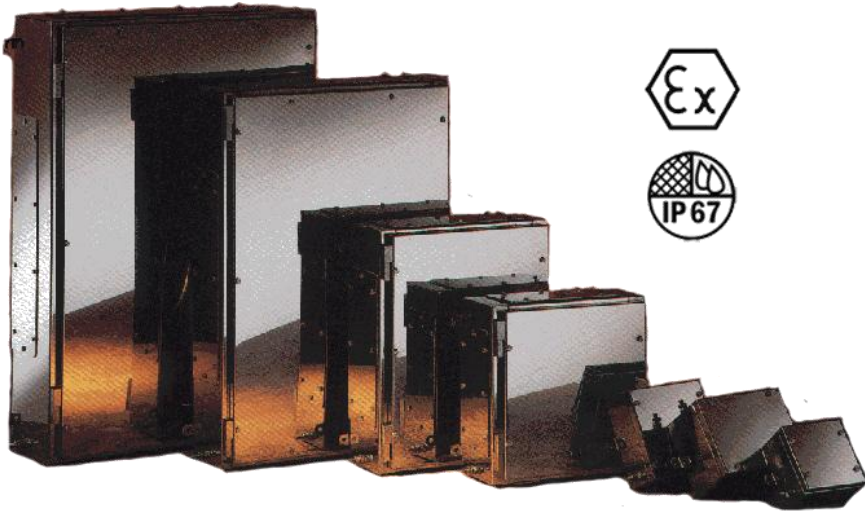

The stainless and mild steel enclosures has been developed using 20 years experience in enclosures for the oil and gas industries. The range combines all of the features demanded by the industry with the benefit of reduced costs of ownership in line with current crine initiatives. By using the latest in computerised manufacturing techniques and improved designs of construction the CEX range offers significant cost savings over other types on the market today.

TECHNICAL SPECIFICATION

MATERIAL:	EITHER 1.5MM THICK 316L STAINLESS STEEL OR MILD STEEL FOR THE BODIES AND LIDS AND 2MM FOR THE GLAND PLATES.
FINISHES:	BRIGHT MIRROR FINISH ON STAINLESS STEEL ENCLOSURES AND POWDER COATED TO RAL 7032 ON MILD STEEL WITH THE OPTION OF HOT ZINC METAL SPRAY GALVANISING FOR INCREASED CORROSION RESISTANCE.
GASKETS:	SINGLE PIECE CLOSED CELL NEOPRENE SINGLE PIECE HALOGEN FREE.
SECURITY:	PADLOCK HASP STANDARD ON SIZES CEX 4, 5, 6, 7 & 8.
TEMPERATURE:	-40°C TO +130°C WITH THE OPTION OF FIRE TESTED VERSIONS WHICH ARE SUITABLE FOR TEMPERATURES OF 950°C FOR THREE HOURS.
FIXINGS:	ALL LID FIXINGS AND GLAND PLATE BOLTS ARE MANUFACTURED FROM STAINLESS STEEL.
DEGREE OF PROTECTION:	BY USING A SINGLE PIECE GASKET ON THE DOOR AND THE GLAND PLATES AND BECAUSE OF THE TURNED OUT FLANGE ON THE ENCLOSURE BODY A MINIMUM OF STANDARD OF IP 66 IS ACHIEVED. FOR A SLIGHT INCREASE IN COST, VERSIONS ARE AVAILABLE TO IP67 AND IP68 UP TO 30 METRES SUBMERSION DEPTH.
APPROVALS:	CERTIFIED TO THE LATEST GENERATION D STANDARDS EEX'E' II T6 TO BS 5501 PART 1 AND PART 6, EN 50 014 AND EN 50 019 AND EEX'I' TO BS 5501 PART 1 AND 7, EN 50 014 AND EN 50 020. ALL SIZES ARE CERTIFIED TO BE FITTED WITH ANY MAKE OF TERMINAL PROVIDED THAT THEY ARE THEMSELVES EEX'E' CERTIFIED. IN ADDITION ALL SIZES ARE COMPONENT CERTIFIED WHICH ALLOWS FOR OTHER APPARATUS TO BE INSTALLED AND A SEPERATE APPROVAL SOUGHT.
WALL MOUNTING:	ALL UNITS ARE FITTED WITH HEAVY DUTY WELDED BACK STRAPS IN 2MM THICK 316STAIN LESS STEEL OR MILD STEEL. THE TOP TWO STRAPS ARE SLOTTED TO FACILITATE EASIER MOUNTING ON A WALL OR FIXTURE.
EARTH STUDS:	AN EARTH STUD SIZE M10 IS STANDARD ON ALL SIZES. AS AN OPTION EARTH STUDS CAN BE FITTED TO ALL GLAND PLATES AND WIRED TOGETHER IN A RING TO THE MAIN ENCLOSURE EARTH STUD.
OPTIONS:	PUNCHED OR THREADED ENTRIES IN EITHER THE BOX WALLS OR GLAND PLATES, COMPONENT MOUNTING PLATES, EARTH BARS ISOLATED OR WIRED TO THE BOX EARTH STUD. FULLY ASSEMBLED EEX'E' CONTROL PANELS WITH INDICATORS, PUSHBUTTONS AND AMMETERS. SPECIAL SIZES TO CUSTOMER SPECIFICATION, PLEASE CONSULT OUR TECHNICAL SUPPORT DESK FOR FURTHER DETAILS.
ACCESSORIES:	A WIDE RANGE OF OPTIONAL ACCESSORIES ARE AVAILABLE FROM THE FOLLOWING LIST: BREATHER DRAINS IN PLASTIC, BRASS OR STAINLESS STEEL, TOP HAT LABEL BRACKETS FOR EXTERNAL LABELLING WITHOUT DRILLING THE ENCLOSURES LIDS. INTERNAL AND EXTERNAL MOUNTING PLATES, FREE-STANDING ANGLE FRAMES FOR REMOTE MOUNTING IN THE FIELD, EXTERNAL RAIN HOODS, FIRE INSULATION FOR CRITICAL LOCATIONS. IN ADDITION TO THE ABOVE ENCLOSURES SIZES WE ARE ABLE TO OFFER FULLY CERTIFIED UNITS IN BESPOKE SIZES PROVIDING THE DIMENSIONS RANGE BETWEEN 143*143*93 MM AND 977*677*208 MM, PLEASE CONSULT OUR TECHNICAL SALES DESK FOR A QUOTATION

Dimensions:

REFERENCE	A	B	C	D	E	F	G	H
Size 1	143	143	93	193	168	---	100	100
Size 2	193	193	93	243	168	---	150	150
Size 3	218	168	130	268	243	---	175	125
Size 4	377	377	156	425	400	275	300	300
Size 5	427	527	156	475	450	425	350	450
Size 6	577	827	156	625	600	700	500	750
Size 7	677	977	208	725	700	850	600	900

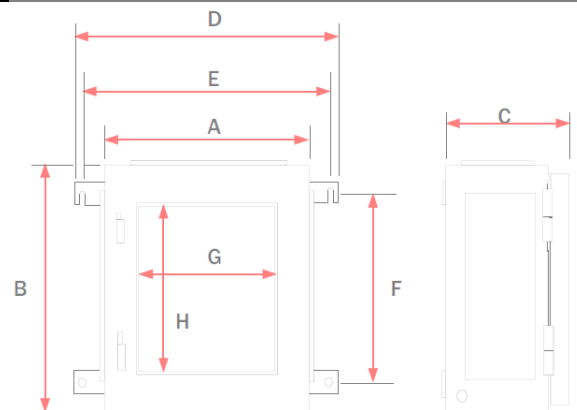

www.tashkoo.com